

# Diagnostic Imaging Extension

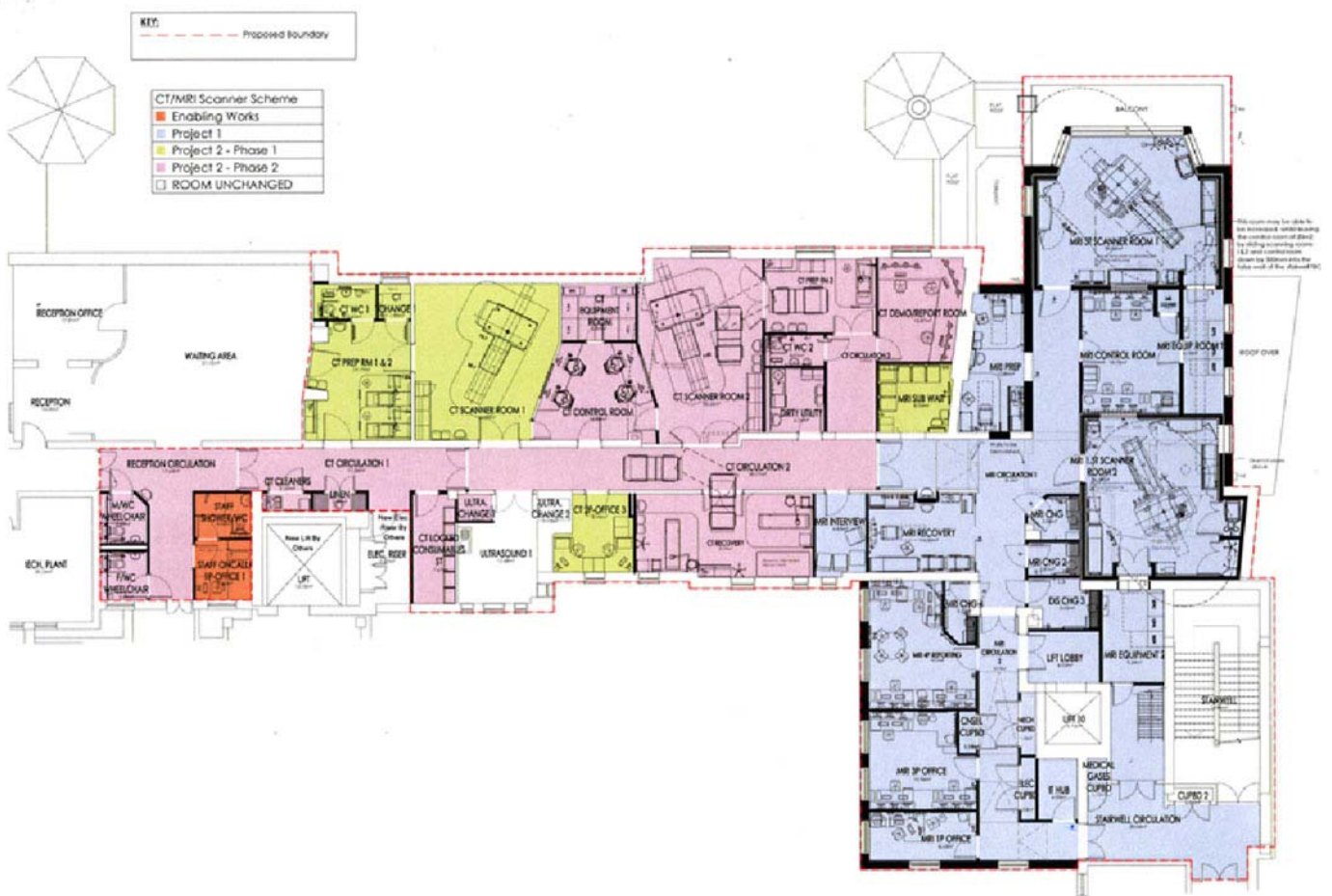
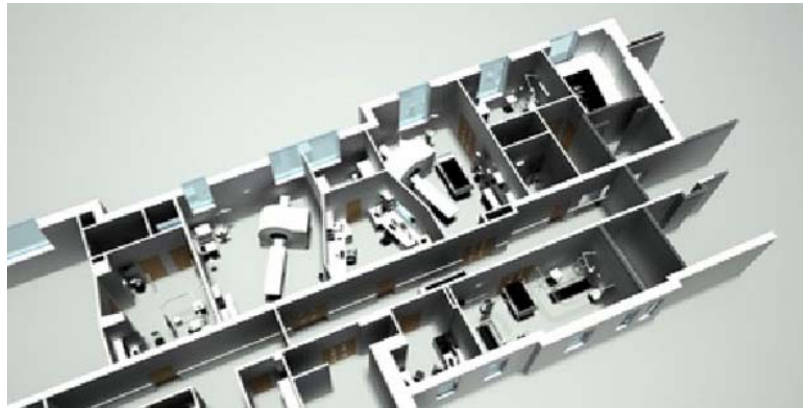

**Client**  
 The Royal Marsden Hospital

**Description**  
 This is a three-phase complex project over 30 months and will double both MRI and CT scanning capacity. Reporting offices are planned into an extension at third floor level, supported by new structure which will penetrate three floors of the hospital, while in full use.

**Innovations & Added Value**  
 Complex structural and architectural design - very exact project planning will ensure the department and hospital can continue to function throughout the contract.

**Status**  
 Complete